

## Technische Daten/ Technical Data

DIANA M100  
thermostatic bath and shower mixer  
DN 15

Ref.: 432600572

Finishes:  
05 chrome

Product description  
Manufacturer DIANA  
Typ: DIANA M100  
thermostatic bath and shower mixer  
Ref.: 432600572

thermostatic bath and shower mixer  
wall mounted  
diverter as rotary ceramic valve  
hot water stop at 40°  
temperature handle with hot water safety  
valve handle with 50% Water consumption  
aerator M28  
shower outlet G1/2  
protected against back flow  
flow rate bath at 3 bar 23 l/min.  
flow rate shower at 3 bar 17 l/min.  
S-unions G1/2 x G3/4  
sieve seal

### Produktabbildung/ Product picture



### Maßzeichnung/ Dimensional drawing

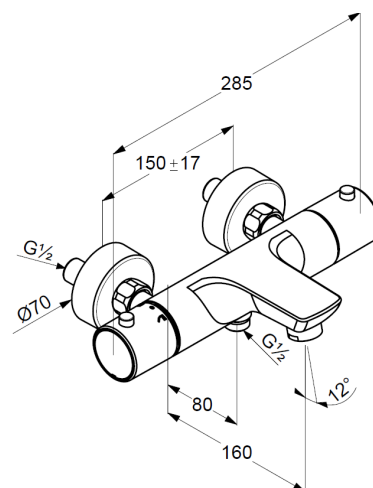

### Durchfluss/ Flow rate

